

Upper Mezzanine/ Esplanade Ballroom Floor Loads: 100 psf

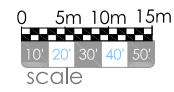

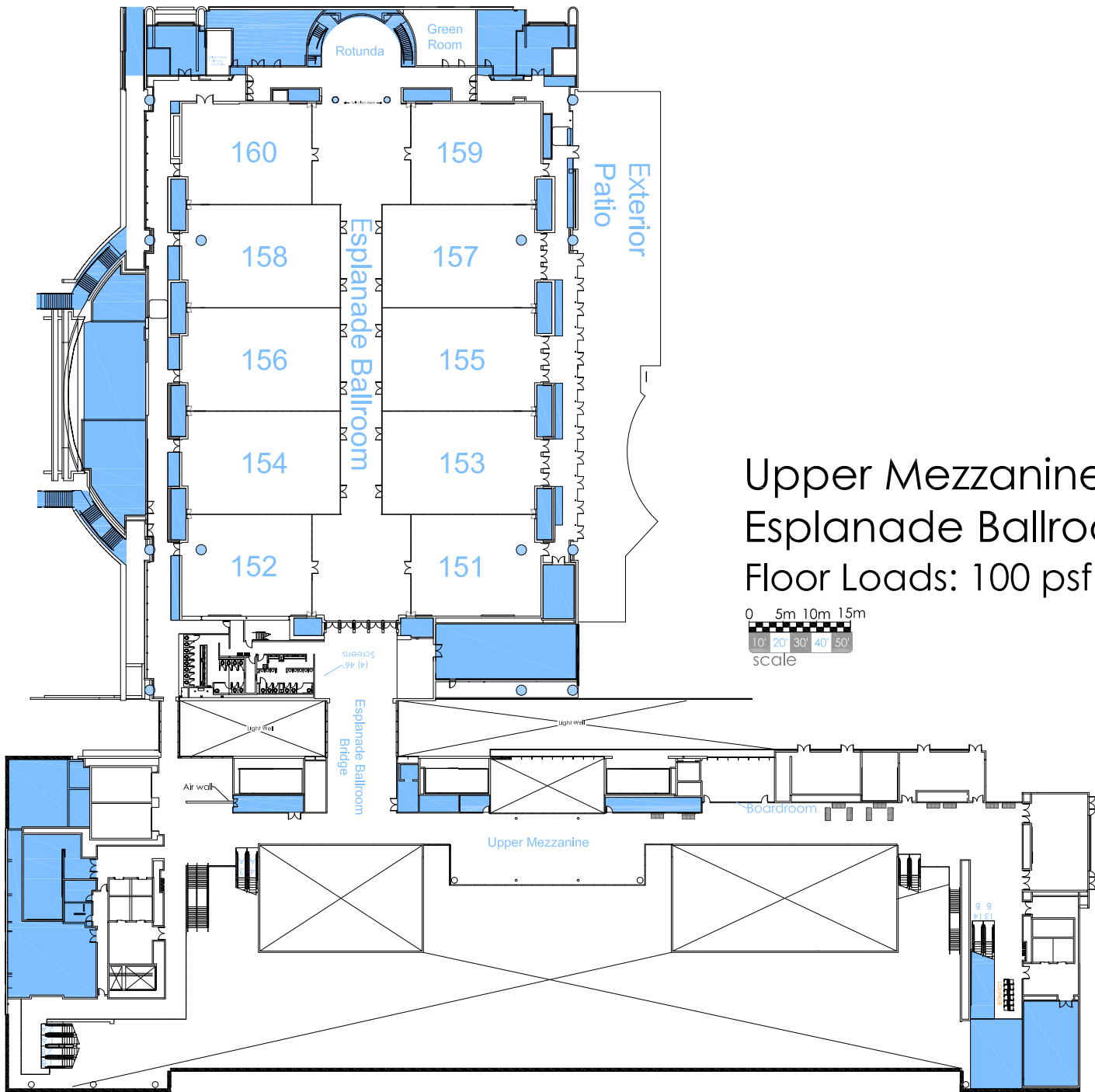

Upper Mezzanine/ Esplanade Ballroom

Floor Loads: 100 psf

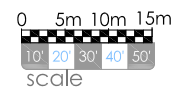

Exhibit Level North/South

Airwalls

Disclaimer:
This drawing is intended as a guide only.
The Moscone Center/SMG cannot be held
responsible for on-site variations or
adjustments.

04 30 2024

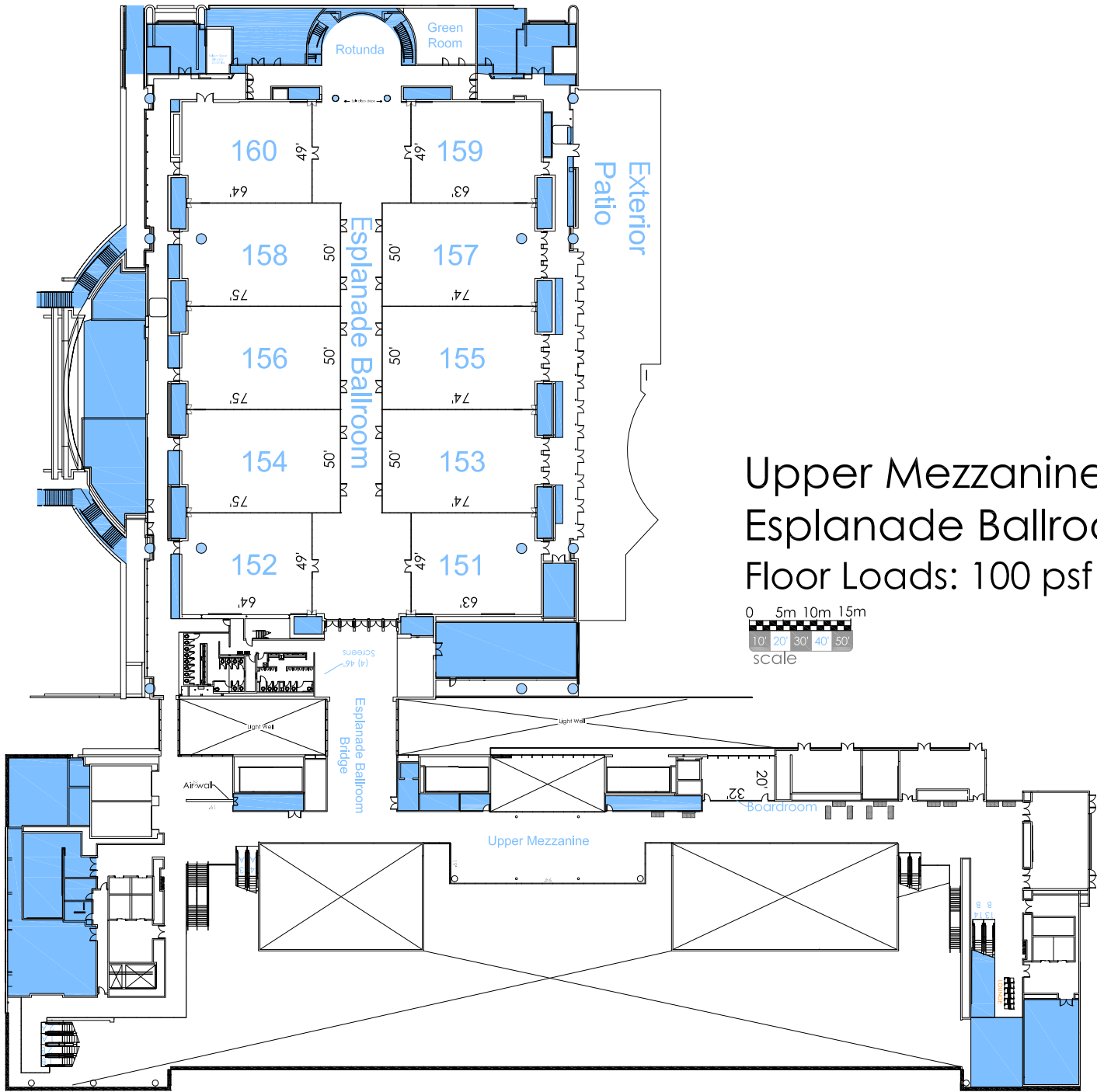
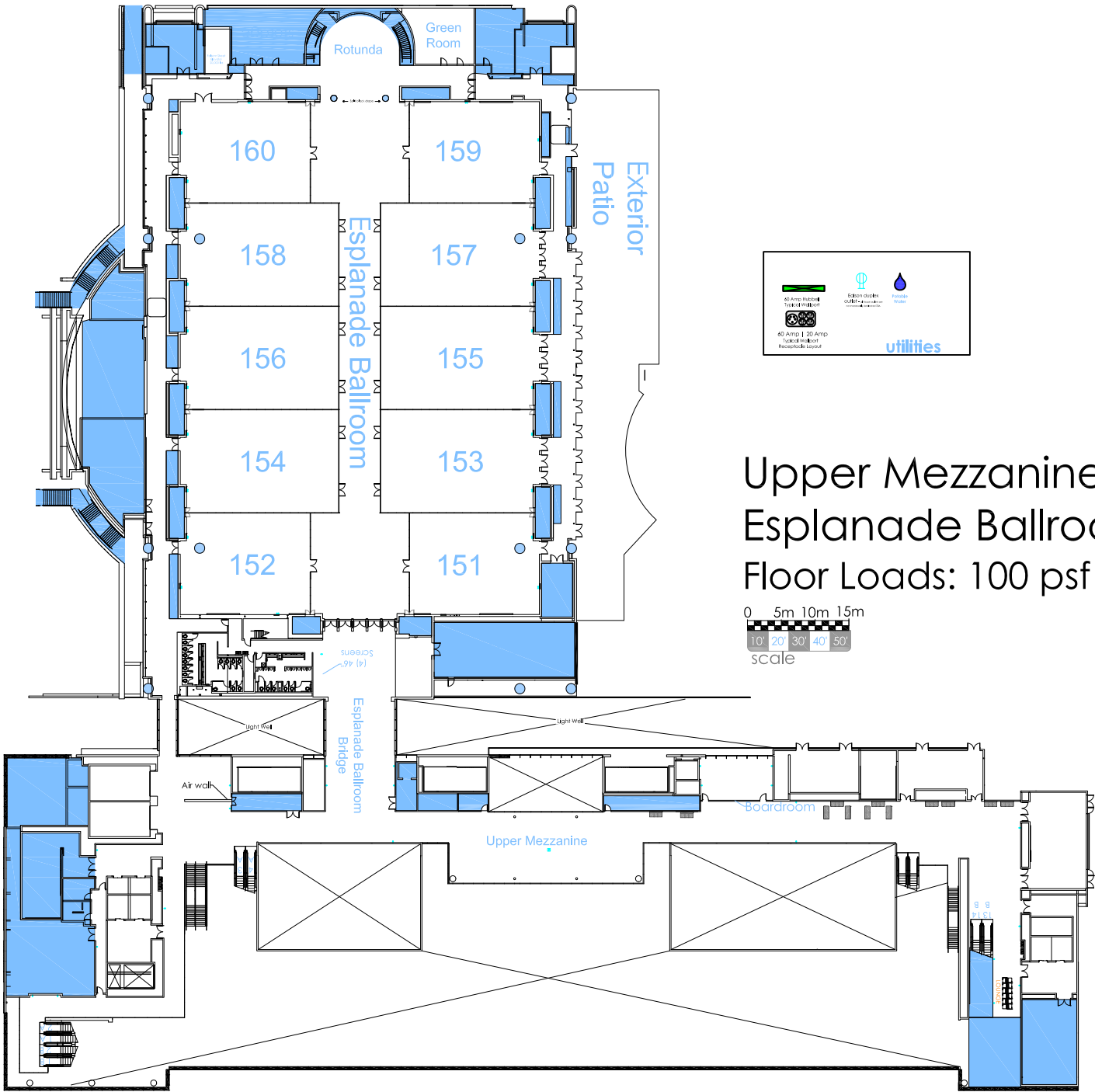

Exhibit Level North/South

Dimensions

Disclaimer:
This drawing is intended as a guide only.
The Moscone Center/SMG cannot be held
responsible for on-site variations or
adjustments.



utilities

- 40 Amp outlet
Typical in Ballroom
- Edison outlet
outlet
- 20 Amp
Typical in Ballroom
- 15 Amp
Typical in Ballroom
- Fresh Water

Upper Mezzanine/ Esplanade Ballroom

Floor Loads: 100 psf

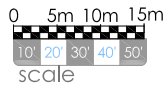

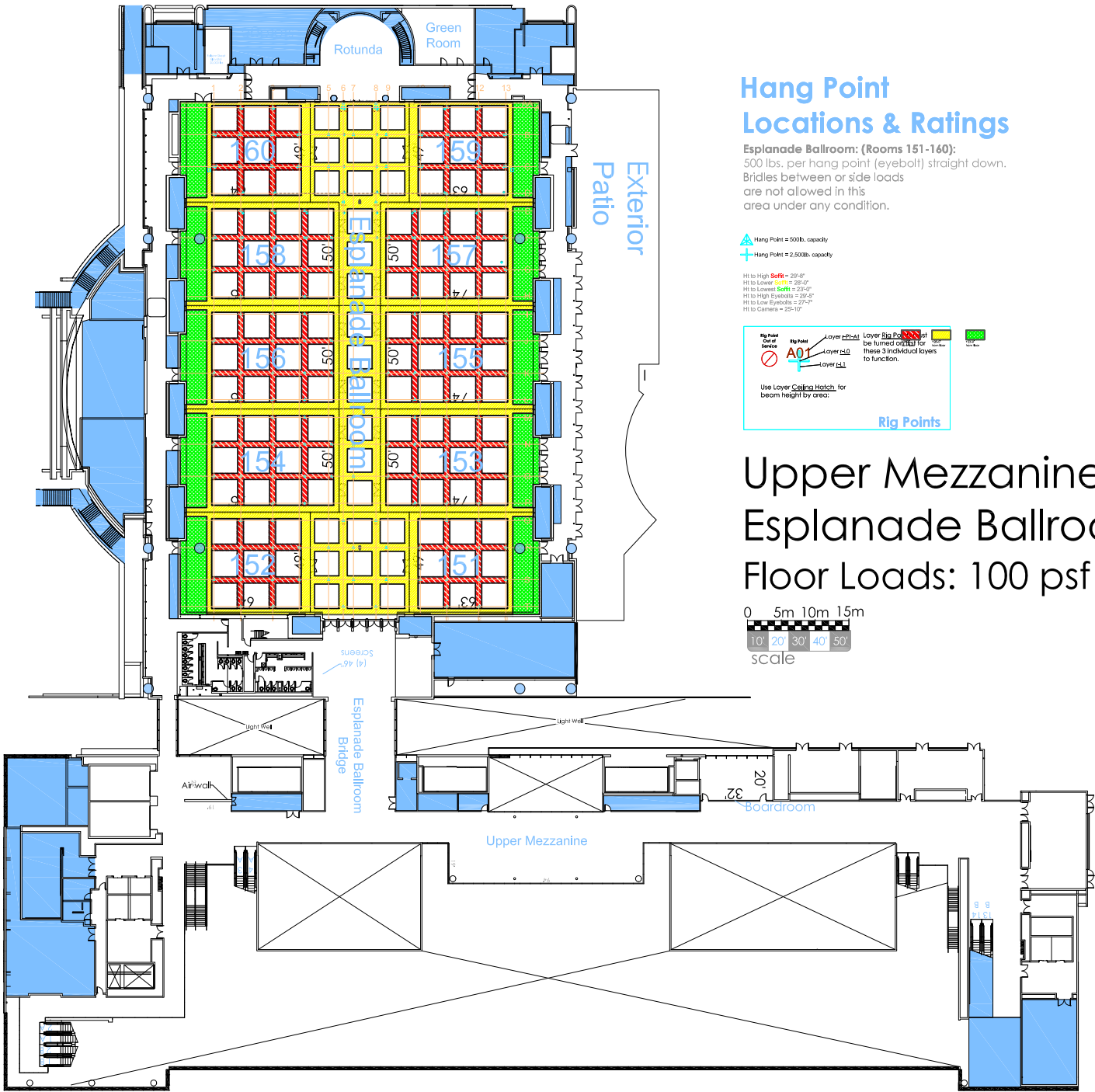

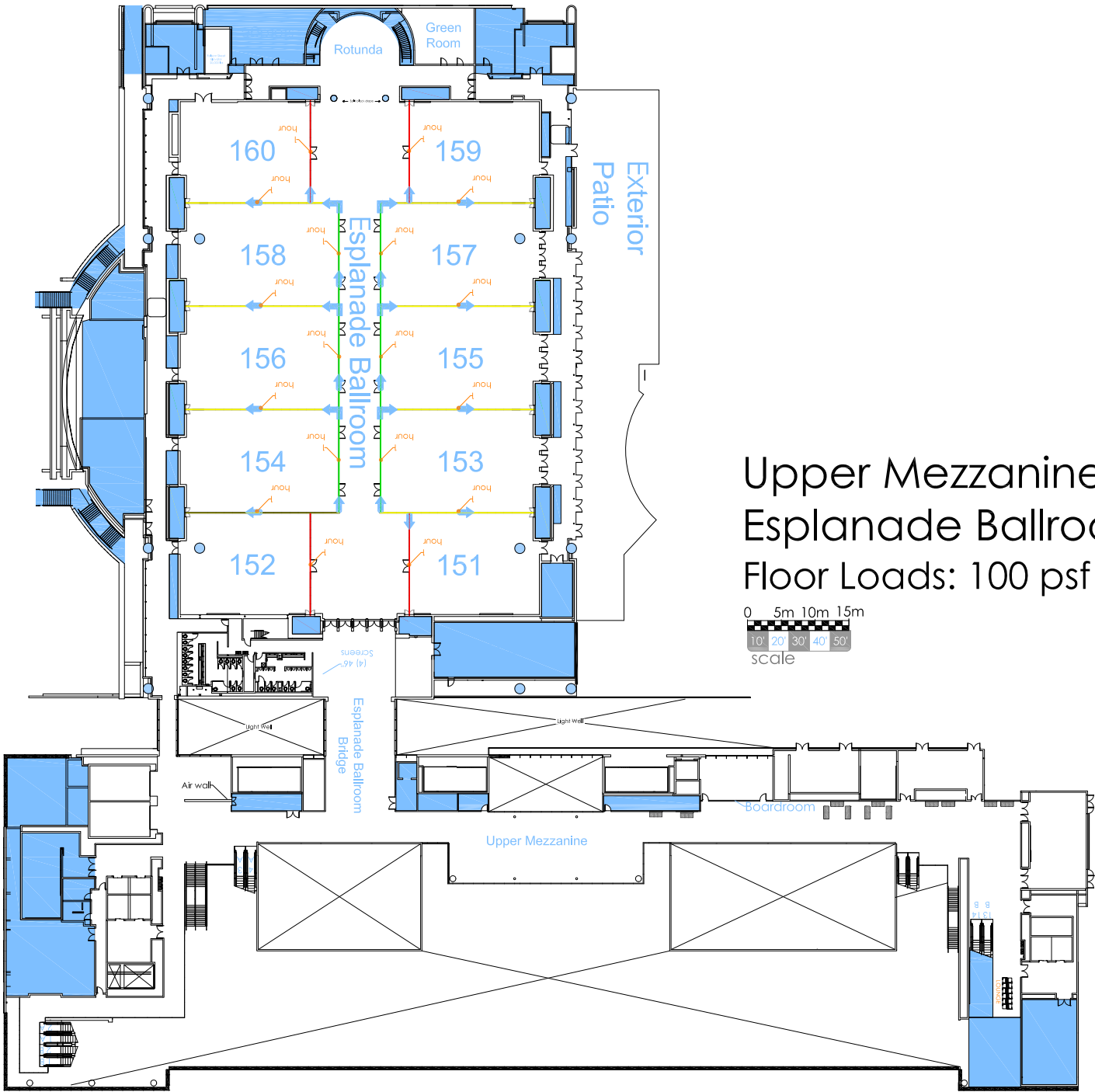

Upper Mezzanine/ Esplanade Ballroom Floor Loads: 100 psf

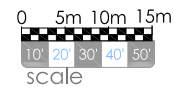

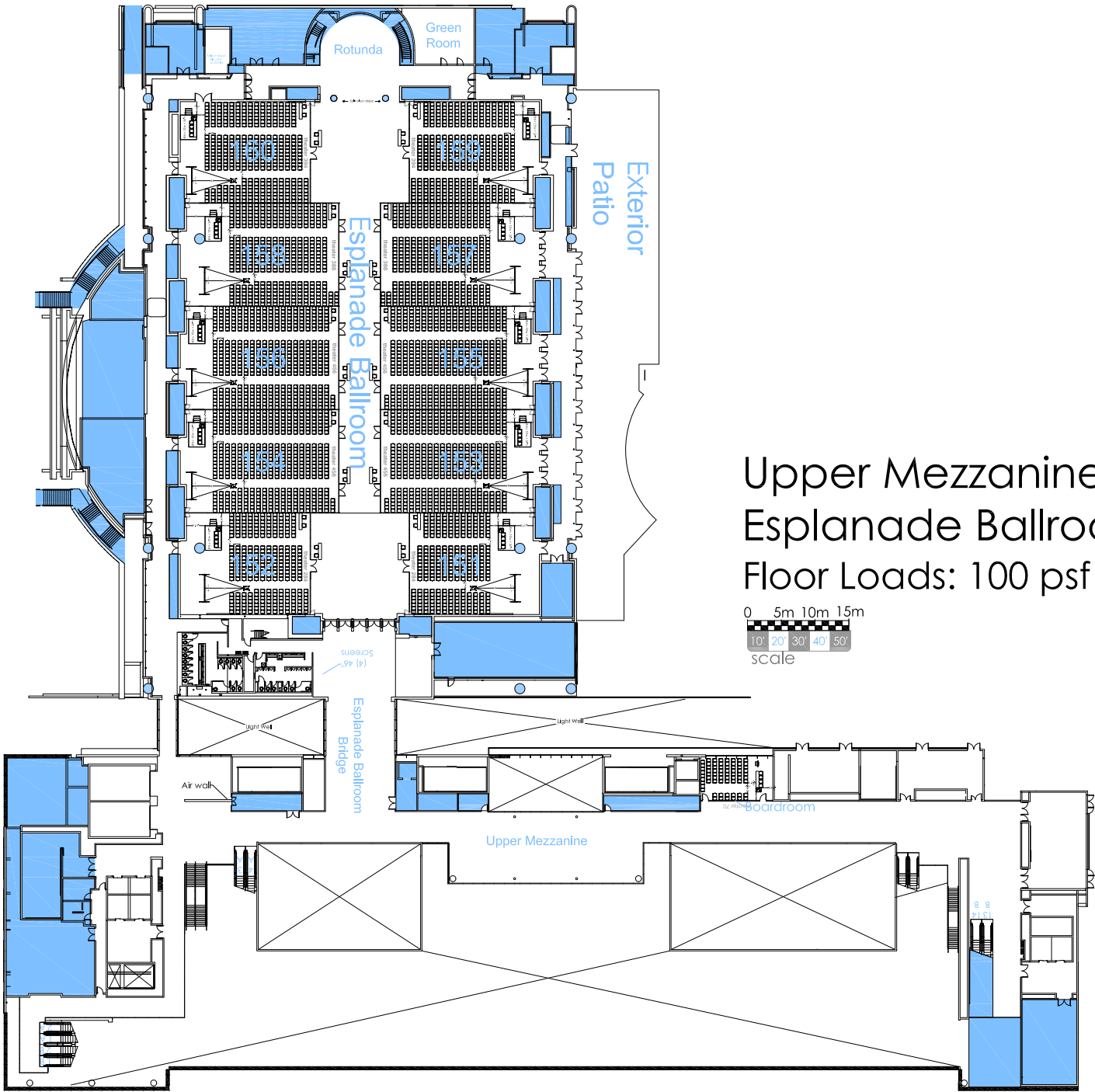

Upper Mezzanine/ Esplanade Ballroom Floor Loads: 100 psf

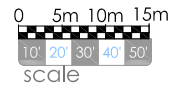

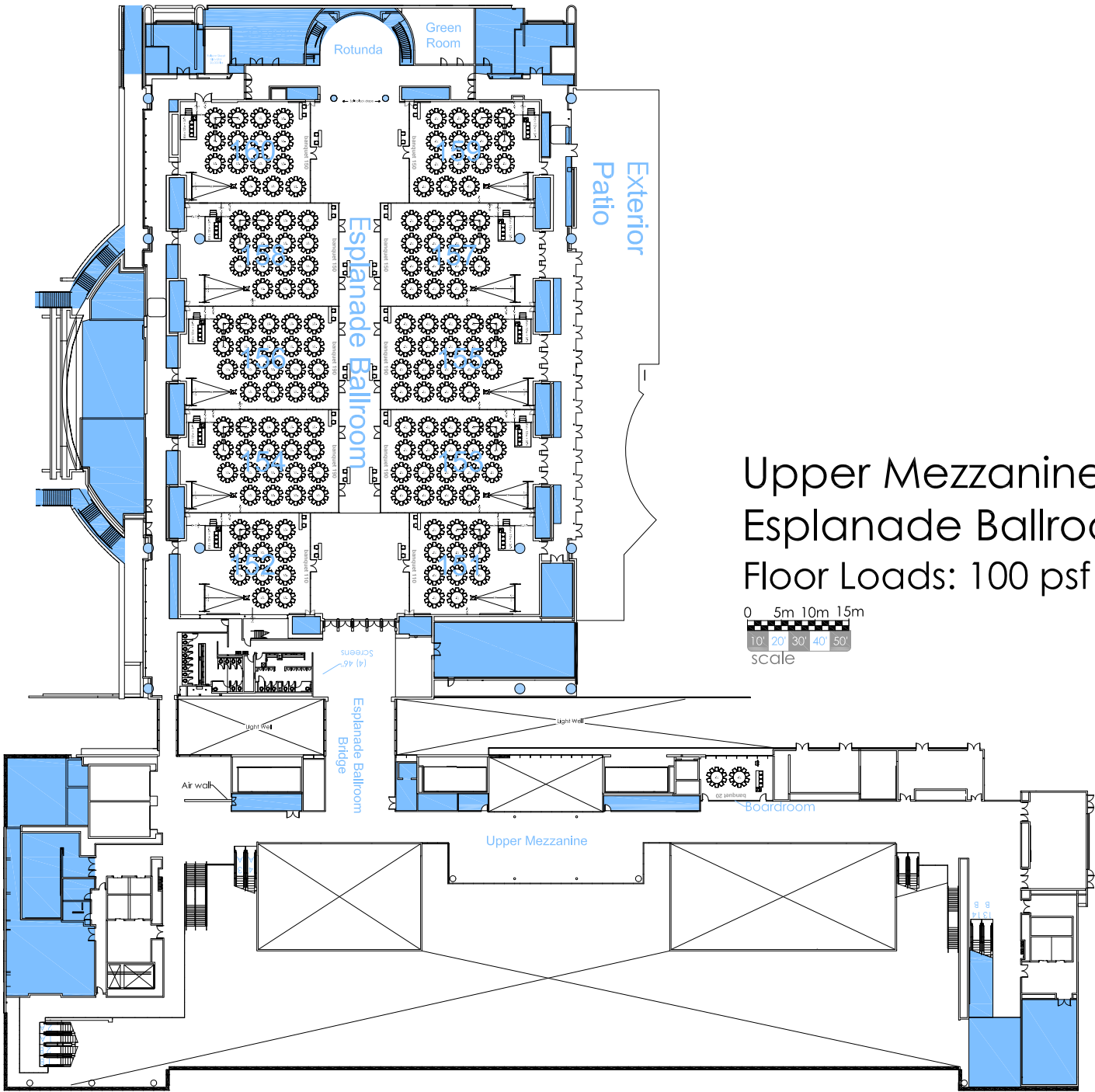

Upper Mezzanine/ Esplanade Ballroom Floor Loads: 100 psf

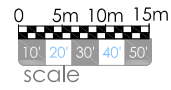

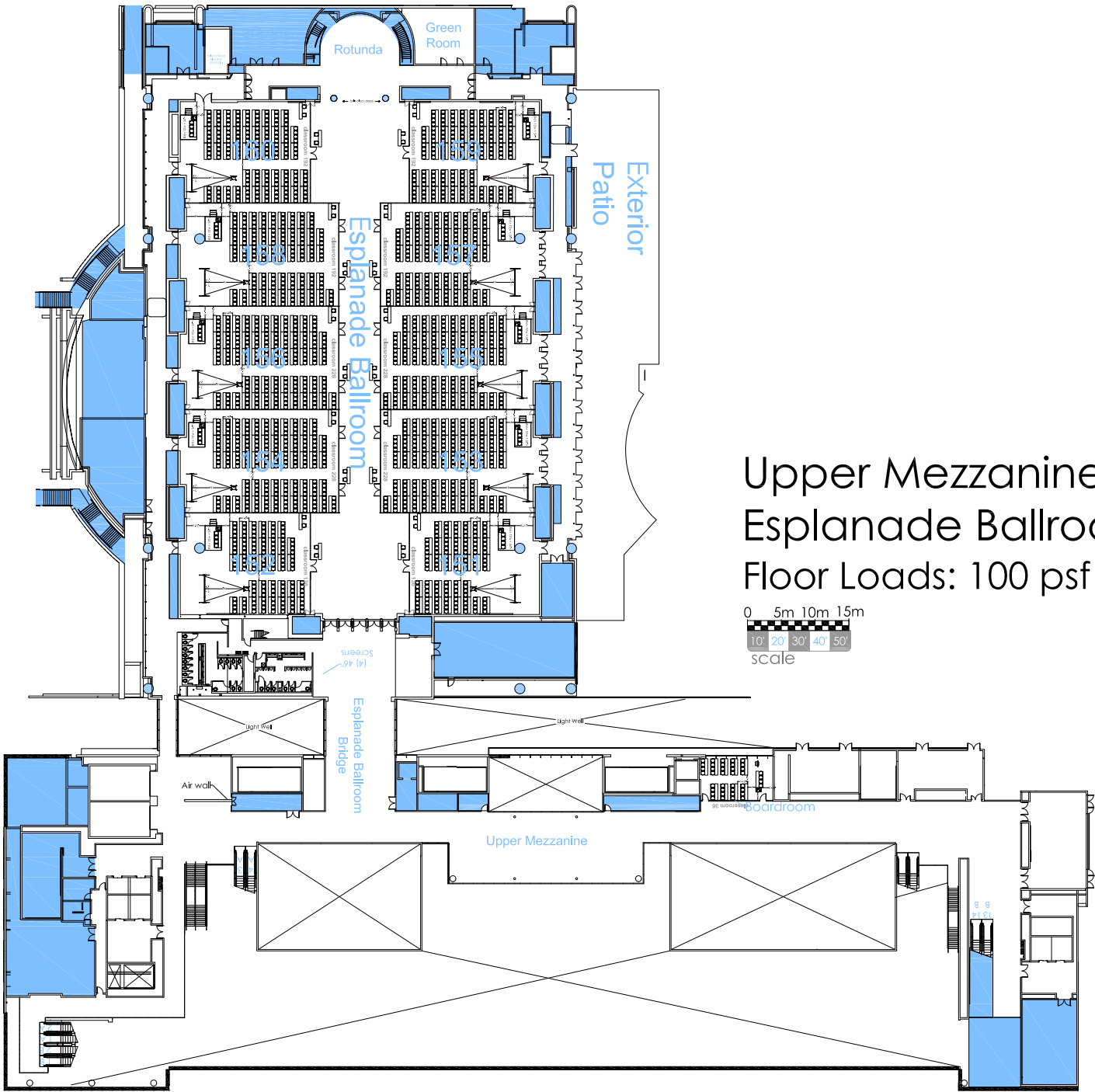

Upper Mezzanine/ Esplanade Ballroom Floor Loads: 100 psf

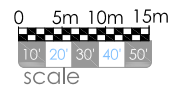

Exhibit Level North/South

Classroom

Disclaimer:
This drawing is intended as a guide only.
The Moscone Center/SMG cannot be held
responsible for on-site variations or
adjustments.